



MAXSET BOW ROLLERS

The MAXSET Bow Roller design guarantees that MAXSET stainless steel and galvanised anchors, along with similar competitor versions, are efficiently self-launched during anchor deployment. When the anchor is fully retrieved, the MAXSET bow roller ensures that the anchor fits securely into the roller and will not rattle around when the boat is under way.



BOW ROLLERS

MAXWELL IS ABLE TO SUPPLY YOU WITH A VARIETY OF BOW ROLLERS FOR CUSTOM OR PRODUCTION LINE BOATS.

MAXSET BOW ROLLERS

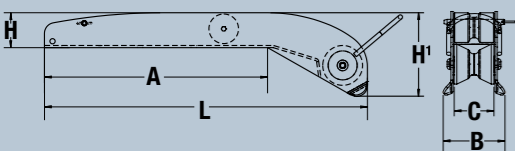
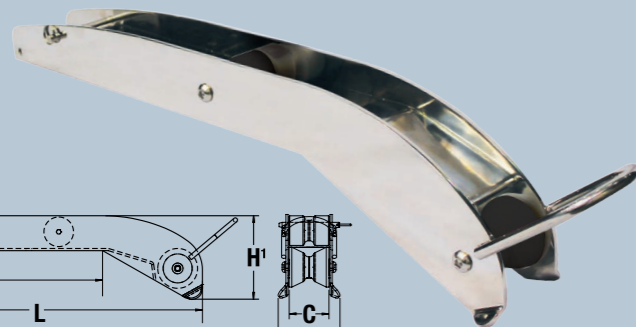

MAXSET ANCHORS AND MAXSET BOW ROLLERS

MAXSET (Delta Style Anchors)	Satin Finish					Polished Finish				
	P105074	P105076	P105078	P105080	P105082	P105075	P105077	P105079	P105081	P105083
4kg/9lbs	•					•				
6kg/13lbs	•					•				
10kg/22lbs		•					•			
16kg/35lbs			•					•		
20kg/44lbs				•					•	
25kg/55lbs					•					•
30kg/66lbs					•					•
40kg/88lbs					•					•

HINGED BOW ROLLER

Suitable for rope and chain anchor rodes utilising up to 13 mm (1/2") chain.



HINGED BOW ROLLER DIMENSIONS

Code	Type	L	B	H	h	C
P104330	Size 1	320 mm (12 5/8")	92 mm (3 5/8")	72 mm (2 7/8")	133 mm (5 1/4")	44 mm (1 3/4")
P104331	Size 2	430 mm (16 15/16")	160 mm (6 5/16")	100 mm (4")	190 mm (7 1/2")	66 mm (2 11/16")

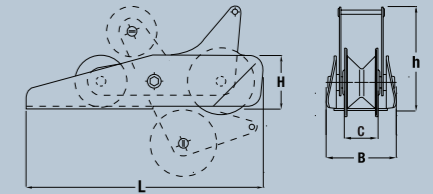

FIXED BOW ROLLER

Suitable for rope and chain anchor rodes utilising up to 13 mm (1/2") chain.



FIXED BOW ROLLER DIMENSIONS

Code	Type	L	B	H	C
P104332	Size 1	205 mm (8 1/8")	72 mm (2 7/8")	74 mm (3")	44 mm (1 3/4")
P104333	Size 2	320 mm (12 5/8")	86 mm (3 7/16")	74 mm (3")	44 mm (1 3/4")
P104334	Size 3	444 mm (17 1/2")	110 mm (4 3/8")	110 mm (4 3/8")	68 mm (2 11/16")

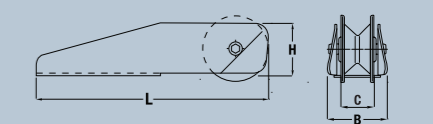

EXTENDABLE HINGED BOW ROLLER

(P104340)

SHORT EXTENSION POSITION

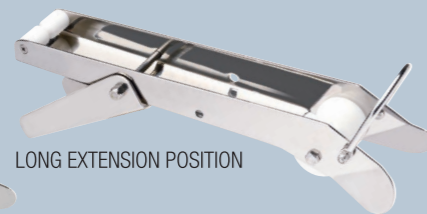

LONG EXTENSION POSITION

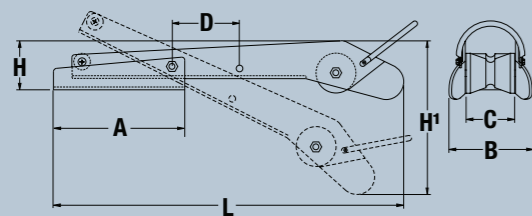

FIXED BOW ROLLER WITH ANCHOR LOOP

(P104345)

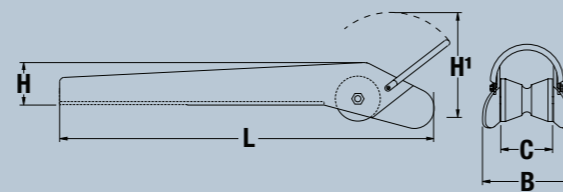

MAXSET ANCHORS AND BOW ROLLERS

MAXSET (Delta Style Anchors)	Standard Bow Roller Codes					
	P104331	P104332	P104333	P104334	P104340	P104345
4kg/9lbs		•	•		•	•
6kg/13lbs		•	•		•	•
10kg/22lbs	•	•	•		•	•
16kg/35lbs		•	•		•	•
20kg/44lbs				•		
25kg/55lbs					•	

MAXCLAW (Claw Style Anchors)	Standard Bow Roller Codes					
	P104331	P104332	P104333	P104334	P104340	P104345
5kg/11lbs		•	•		•	
8kg/18lbs		•	•		•	
10kg/22lbs	•	•	•		•	
15kg/33lbs				•	•	
20kg/44lbs				•		

MAXSET AND STANDARD BOW ROLLER DIMENSIONS

	Extendable P104340	Fixed with Hoop P104345	P105074 P105075	P105076 P105077	P105078 P105079	P105080 P105081	P105082 P105083
A	198 mm (7 13/16")	N/A	315 mm (12 3/8")	414 mm (16 5/16")	480 mm (18 7/8")	510 mm (20")	560 mm (22")
B	125 mm (4 15/16")	134 mm (5 1/4")	84 mm (3 5/16")	112 mm (4 3/8")	112 mm (4 3/8")	114 mm (4 1/2")	153 mm (6")
C	73 mm (2 7/8")	75 mm (3")	62 mm (2 1/2")	78 mm (3")	78 mm (3")	78 mm (3")	105 mm (4 1/8")
D	101 mm (4")	N/A	N/A	N/A	N/A	N/A	N/A
H	75 mm (2 15/16")	65 mm (2 9/16")	55 mm (2 1/8")	65 mm (2 1/2")	72 mm (2 13/16")	78 mm (3")	95 mm (3 3/4")
H'	239 mm (9 3/8")	155 mm (6 1/8")	122 mm (4 13/16")	152 mm (6")	165 mm (6 1/2")	175 mm (6 7/8")	215 mm (8 1/2")
L	527 mm (20 1/4")	460 mm (18 1/8")	465 mm (18 5/16")	600 mm (23 5/8")	715 mm (28 1/8")	762 mm (30")	850 mm (33 1/2")

CHAIN STOPPERS

Chain stoppers hold the chain and take the load off the windlass. They are used to set and ride on the anchor, break free the anchor or to prevent accidental 'free fall' of the anchor while under way. Also recommended for VW Series rope and chain systems to hold the chain while changing over from rope to chain. Maxwell offers three chain stopper variations to suit any installation configuration of chain stopper and windlass combination.



Height Matched



Levered



Economy

The latest "Height Matched Stopper" has been developed for use with Maxwell's rope/chain series of vertical windlasses, avoiding the need for a height adjustment plinth to most effectively align the chain with the windlass chainwheel during anchor deployment and retrieval.

Refer to the adjoining chart for available chain stopper types and sizes. Consult the Maxwell Superyacht catalogue for larger size chain stoppers.

CHAIN STOPPER DIMENSIONS

	Height Matched		Levered			Economy
	RC8 (P104358)	RC10/12 (P104359)	8 mm (P104372)	10 mm (P104373)	13 mm (P104374)	8/10 mm (P104335)
B	105mm (4 1/8")	127mm (5")	72 mm (2 7/8")	86 mm (3 7/16")	105 mm (4 3/16")	62 mm (2 3/8")
C	40mm (1 9/16")	48mm (1 7/8")	20 mm (7/8")	20 mm (7/8")	26 mm (1 1/8")	6 mm (1/4")
F	150mm (5 15/16")	182mm (7 3/16")	152 mm (6")	190 mm (7 1/2")	219 mm (8 5/8")	80 mm (3 1/8")
G	130mm (5 1/8")	159mm (6 1/4")	92 mm (3 5/8")	130 mm (5 1/8")	159 mm (6 5/16")	46 mm (1 3/4")
G'	10mm (7/16")	11.5mm (1/2")	30 mm (1 3/16")	30 mm (1 3/16")	30 mm (1 3/16")	17 mm (5/8")
I	77mm (3")	97mm (3 13/16")	70 mm (2 7/8")	86 mm (3 1/2")	100 mm (4")	92 mm (3 5/8")
J	44mm (1 3/4")	53mm (2")	31.5 mm (1 1/4")	44 mm (1 3/4")	53 mm (2 1/8")	N/A
J'	8.8mm (11/32")	12.5mm (1/2")	10 mm (7/16")	10 mm (7/16")	12.5 mm (1/2")	37 mm (1 1/2")
K	61.5mm (2 7/16")	78mm (3")	51.5 mm (2 1/8")	64 mm (2 5/8")	78 mm (3 1/8")	74 mm (2 7/8")
L	90mm (3 1/2")	125mm (4 15/16")	95 mm (3 3/4")	95 mm (3 3/4")	130 mm (5 1/8")	N/A
M	M8	M10	M10	M10	M12	M10

